

NEW STYLE



UNISEX BAGS
SXI48 - LIGHT TOTE BAG



Light Woven tote bag

- Top edge double folded for strength and clean finish
- Long handles with reinforced cross stitch

Combo options

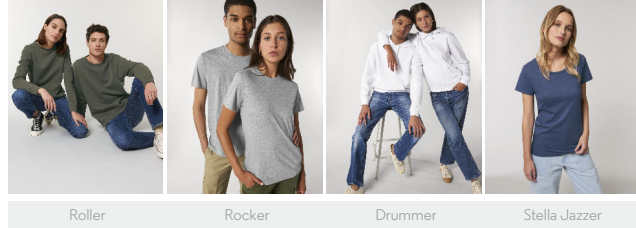

WHITES



COLORS



Shell : Plain Weave , 100% Organic ring-spun combed cotton , Fabric washed , 160 GSM

Printing Specifications

For suitable print techniques, please download our printing guide

Certifications & memberships



Wash Instructions

Wash similar colours together, no ironing on print, wash and iron inside out.

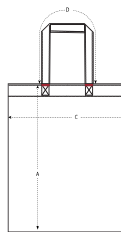

SIZES		OS
A	Height	42
C	Width	37
D	Strap Length	65